

Santa Fe River Properties

Surrounding Attractions



- A. O'leno State Park
- B. River Rise State Park
- C. Ichetucknee Springs State Park
- D. Troy Springs State Park
- E. Manatee Springs State Park

- F. Suwannee River State Park
- G. Ginnie Springs
- H. Hart Springs
- I. Wine Tasting
- J. Blue Springs

Addresses

Three Rivers Inn
1850 NE 128th Place
Branford, FL

Three Rivers Cottage
1640 NE 127th Lane
Branford, FL

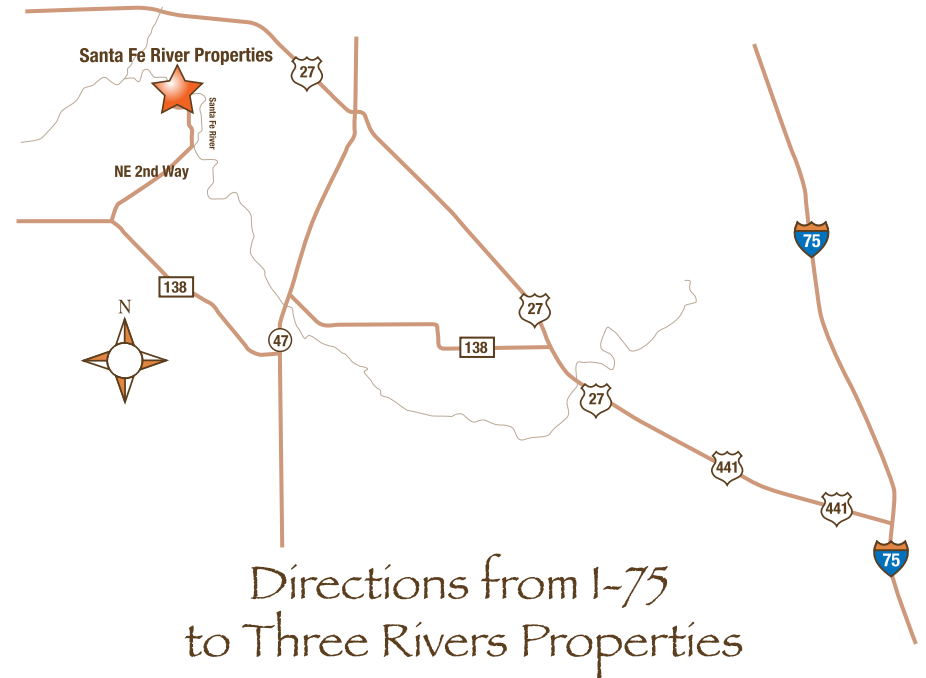

Directions from I-75 to Three Rivers Properties

- From I-75, take exit 399 (old exit #78) North of Gainesville
- Take US 441 "North" (West) towards High Springs
- At 5 miles veer left on US 27
- At 4.0 miles (flashing light) turn left on C-138
- At 6.6 miles (dead end) turn left on US 47
- At 1.2 miles turn right on C-138
- At 4.9 miles turn right on NE 2nd Way (dirt road)
- At 2.4 miles veer left on NE 2nd Way
- At 0.2 miles veer left on NE 2nd Way
- At 0.5 miles (dead end) turn left on 128th Place until you reach the Inn at 1850 (right side of the road)
- To reach the Cottage, continue on 128th making a right on 127th Lane until you see 1640 (first house on right)